



Ace Motorhomes Quick Start Guide

CONTENTS

Power up motorhome	3
Prime the cold water system	4
Connect gas to motorhome	5
Operate Fridge RC10.4T Compressor	6
Operate Fridge NRX80 Compressor	6
Operate Fridge Absorption Fridge	6
Operate Truma Combi Neo	7
Operate Whale space heater	9
Operate Whale water heater	12

NB. If after following any of the steps in this guide a problem occurs, please first consult your main handbook for further information, and if problems still persist contact your supplying dealer.

The main motorhome owners handbook can be found on the Ace Motorhomes website:

www.acemotorhomes.com/owners/handbook



POWER UP MOTORHOME

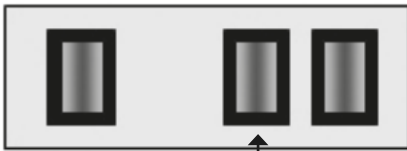
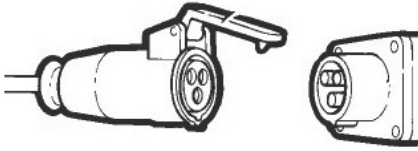

CHARGER



HEATING/HOT WATER



1. Plug 230v supply into motorhome then into site supply (if appropriate).
2. Press Black isolator button on front of power supply unit to turn system on.
3. Press green button on power supply unit to switch on charger.
4. Press Yellow button on power supply unit to switch on 230v supply to heating system.
5. Press power button on control panel (above entrance door).

NOTE: The leisure battery in your motorhome may also receive charge while driving, however this does depend on the operation of the smart alternator in the base vehicle, as the smart alternator will prioritise maintaining the vehicle (engine) battery.

PRIME THE COLD WATER SYSTEM

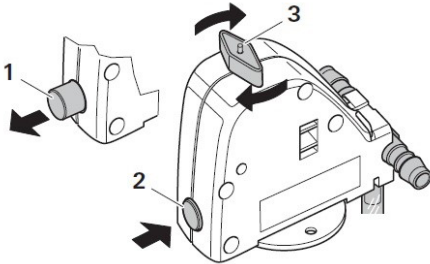
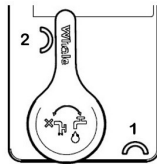

1. Ensure the drain valve is closed, so that the fresh tank can hold water: For 1200 GL and SL, locate the fresh tank valve in the rear nearside bed cupboard. For the 1200 RL and all 1500 locate the blue external valve at the skirt of the motorhome, and close the valve.

Then, locate and open the fresh water tank filling cap on the body side, and use a food grade hose to fill the water tank.

2. Locate safety drain valve close to Whale or Truma appliance.

For Whale, rotate handle to position (2).

For Neo push rotate handle on top of valve to position shown (3) and push button on side of valve in (position 2). If button does not stay in position 2, temperature may be too low. Turn on space heating, wait, and try again.

Close all taps except kitchen sink tap, which should be set to 'hot' position.

3. Press pump button on control panel, and wait until water is flowing from kitchen tap (this may take a few minutes).

4. Set kitchen tap to 'cold' and again wait, until water is flowing cleanly.

At vanity and shower taps / mixers, open to hot and then to cold until again water is flowing cleanly at each outlet.

CONNECT GAS TO MOTORHOME

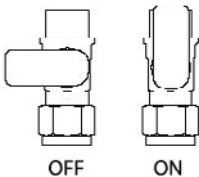
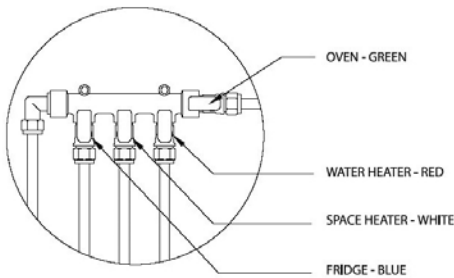
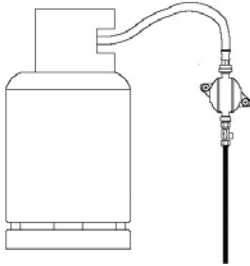

1. Position the gas bottle and tighten the securing straps, then fix hose to regulator, and tighten using spanner. Fix other end of hose to gas bottle, again tightening using spanner.

Turn valve on top of gas bottle to turn on gas supply, and if regulator is 'Crash Sensor', follow steps described on Yellow label close to regulator to re-set safety features.

2. Locate gas isolation valves, which may be assembled onto a manifold or be in the format of a separate tap fitted close to an appliance.

NOTE: There may be multiple manifolds in the vehicle.

3. Turn each tap to the 'ON' position.

4. Move to hob/oven. Open glass lid fully. Press igniter on hob, turn one burner control to 'ON' position, and depress that control. After a short while burner should light.

Gas should now be available at all appliances.

OPERATE FRIDGE RC10.4T COMPRESSOR

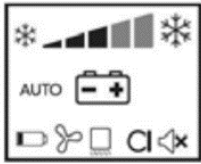

This guide details basic settings only, please see main handbook and links to external sources for further information.

If possible, cool the fridge to the preferred temperature the night before starting your holiday.

Turn ON

Press and hold the rotary control (see above) for approx. 2 seconds to switch on the fridge.



The fridge will start with the last used / previous settings. To change settings such as temperature press the rotary control briefly, and then rotate the control to move through the options.

Once the setting is highlighted, a further press and rotation of the rotate control adjusts the setting – see the full instructions for further details.

Please note a long press of the rotary control (approx. 4 seconds) will turn the fridge OFF

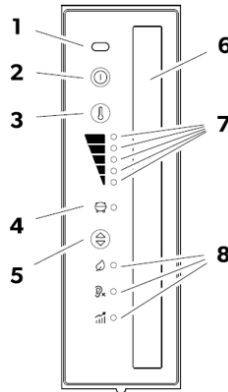
OPERATE FRIDGE NRX80 COMPRESSOR



-  Eco mode: Cooling levels 1 to 3, reduced energy consumption
-  Quiet mode
-  Performance mode

This guide details basic settings only, please see main handbook and links to external sources for further information.

If possible, cool the fridge to the preferred temperature the night before starting your holiday.

Open the fridge door, to access the controls which can be seen above (Item no. 6 on the image above is the interior light for the fridge)

Turn ON

Press the power button (2) for approx. 2 seconds to switch on the fridge.

Set maximum cooling level

Press the button (3) repeatedly to select the preferred level of cooling

Set operation mode

Pressing button (5) cycles through the operating modes. Choose the preferred mode as indicated by (8) and described above, please note the choice of mode will affect the maximum cooling level

Close door

OPERATE FRIDGE ABSORPTION FRIDGE

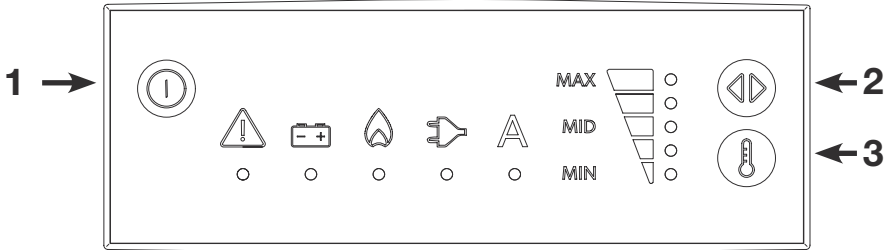

This guide details basic settings only, for further details, please see main handbook and links to external sources for further information.

TURN ON

Press the power button (1) for approx. one second to switch on the fridge. Pressing and holding the button (1) for approx. one second again, will switch off the fridge.

Choose energy source

Press button (2) to move between the energy source choices. From left to right these are:

 12v (from towing vehicle)

 Gas

 230v (mains hook up)

 Automatic selection of available source

An LED will illuminate below the corresponding symbol to confirm the chosen energy source.

Choose temperature:

Press button (3) to choose a temperature. With all indicators illuminated, maximum cooling will occur.

After a short time the fridge will begin to operate. If a problem occurs (for instance no gas when gas energy source is selected), then the LED below the warning symbol will illuminate. Please note; allow the refrigerator to run for at least two hours, or ideally run the refrigerator over night, to cool to a suitable temperature for storage of food.

OPERATE TRUMA COMBI NEO



The Truma Combi Neo can provide hot water, from gas and mains (230v) electric energy sources. Follow the steps earlier in this guide to prime the water system, before attempting to heat water.

The Truma Combi Neo can also provide room heating, from gas and mains (230v) electric energy sources. Room heating is possible with or without priming the water system.

This guide provides basic settings only, for more detailed instructions see the Truma Combi Neo information in the handbook, or supplied as instructions with your motorhome.

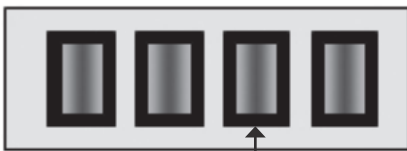

Heating/Hot water

The Orange 230v / Mains isolation switch on the Power Supply Unit must be ON / illuminated for electric operation of the Combi Neo.

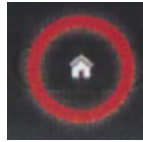

To turn heating system ON, press the HOME button. From any point the instructions below, pressing the home button again, will return you to the screen shown below.

To provide hot water:

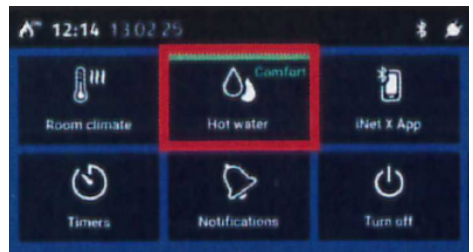

First press the Hot Water tile on the home screen.

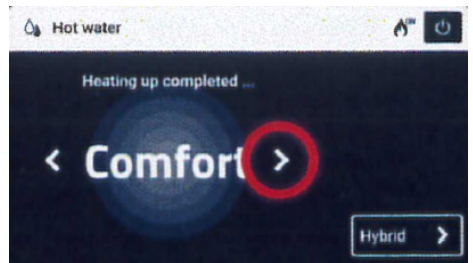

On the hot water page, pressing the arrow highlighted above will allow selection of 'Comfort' (normal hot water use) or 'Shower' (high amount of hot water use).

Next, press the tile at the bottom right of the screen (shows 'Hybrid' on image) to select an energy source.

OPERATE TRUMA COMBI NEO

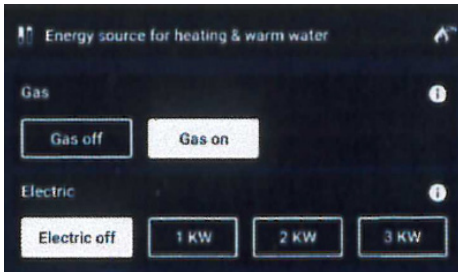

Press the upper right tile on the screen 'Gas on' to select gas operation.

For heating using the 230v / mains electric supply, select 1kW, 2kW or 3kW. A higher number will reduce the time taken to heat water, but, will also consume more power. It is also possible to select combinations of Gas and Electric operation.

Water heating will now start, and if required the 'home' button can be used to return to the home screen.

To turn on room heating:

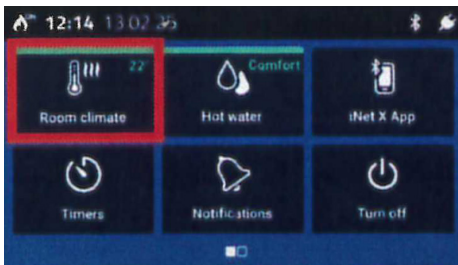

First press the 'Room climate' tile



On the 'Room climate' page, use the – and + buttons to select a target room temperature.

At the top right of the screen the 'Comfort' tile is highlighted. If a quicker heat up is required, press 'Boost'.

Next, press the tile at the bottom right of the screen (shows 'Hybrid' on image) to select an energy source.

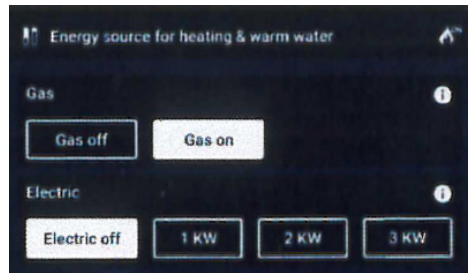

Press the upper right tile on the screen 'Gas on' to select gas operation.

For room heating using the 230v / mains electric supply, select 1kW, 2kW or 3kW, a higher number will reduce the time taken to achieve target temperature, but, will also consume more power. It is also possible to select combinations of Gas and Electric operation.

Room heating will now start.

NOTE: Only one set of energy selections can be made on the Combi Neo, at any one time. That set of energy settings will be applied to both the water heating, and the room heating.

WHALE SPACE HEATER



Locate the space heater control above the sliding door on your motorhome.

To select room temperature

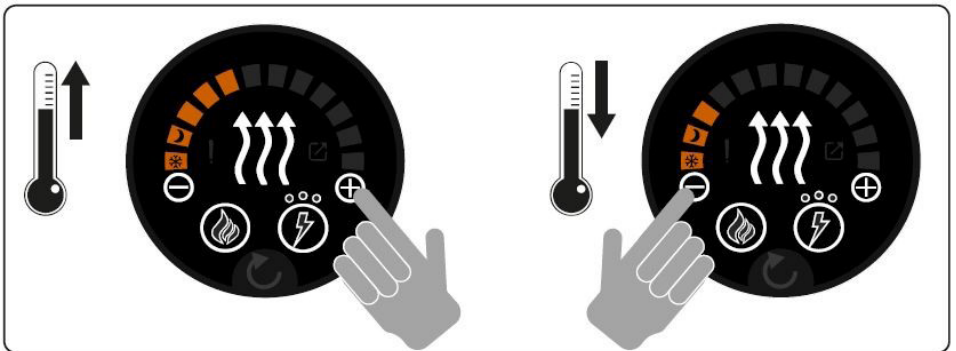

Press the '+' and '-' buttons on the controller to choose the desired temperature, as shown by the gauge which runs around the upper perimeter of the control.

WHALE SPACE HEATER

To select energy source

Gas Operation

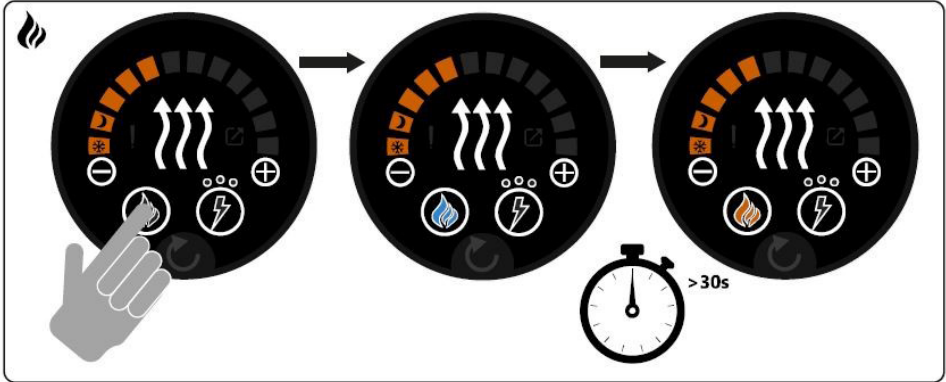

Press the 'flame' button on the control once. After approx. 30 seconds, the colour of the 'flame' button will change from Blue to Orange, to show that gas heating is in operation.

Electric Operation (Only available when a mains hook up is connected)

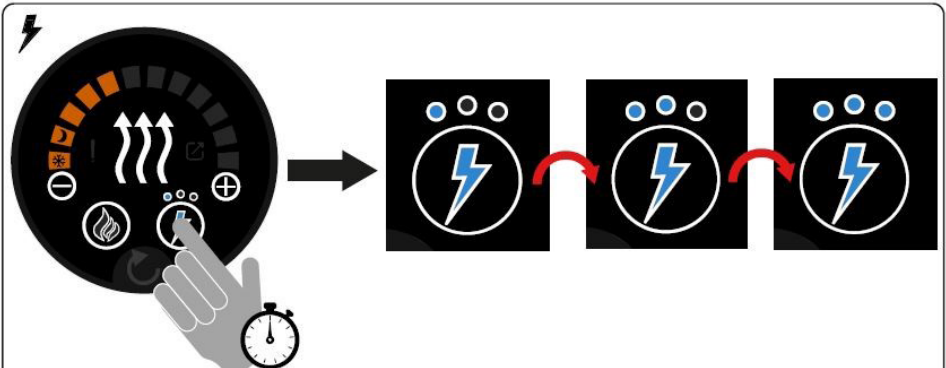

Press and hold the 'lightening' button on the controller to cycle through 0.75kW heating (One LED illuminated above button), 1.5kW (two LED's illuminated above button), and 3.0kW (three LED's illuminated above button) settings. Let go of the button when the desired setting is selected.

WHALE SPACE HEATER

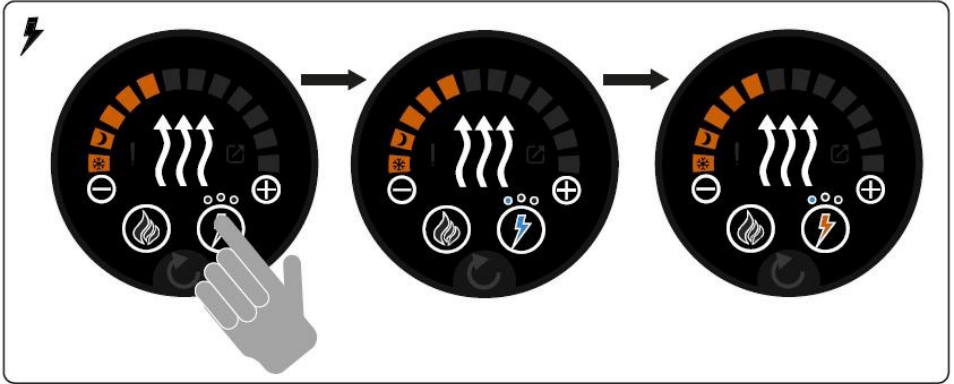

A single press of the 'lightening' button with turn electric heating ON and OFF. When the button changes from Blue to Orange illumination, this confirms that electric heating is operational.

WHALE WATER HEATER – ROUND CONTROL



Locate the water heater control above the sliding door on your motorhome

To select water temperature

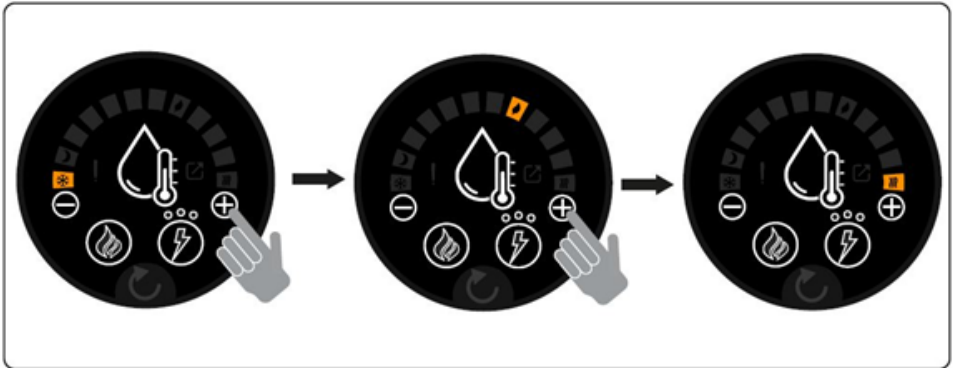

Press the '+' and '-' buttons on the controller to choose the desired temperature, as shown by the gauge which runs around the upper perimeter of the control

WHALE WATER HEATER ROUND CONTROL

To select energy source

Gas Operation

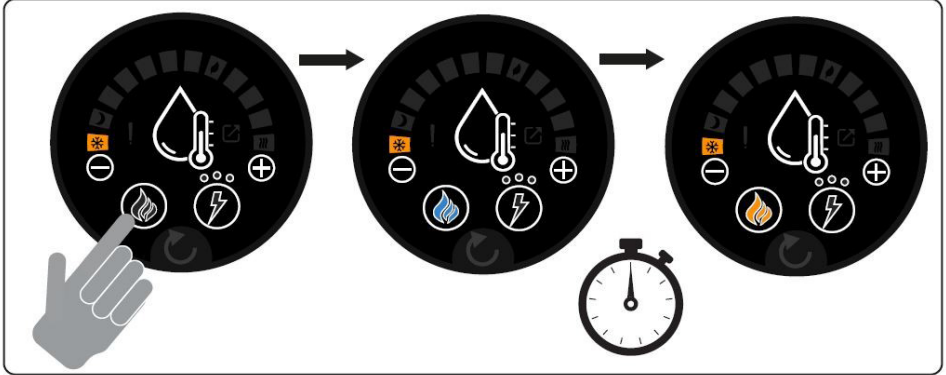

Press the 'flame' button on the control once. After approx. 30 seconds, the colour of the 'flame' button will change from Blue to Orange, to show that gas water heating is in operation

Electric Operation (Only available when a mains hook up is connected)

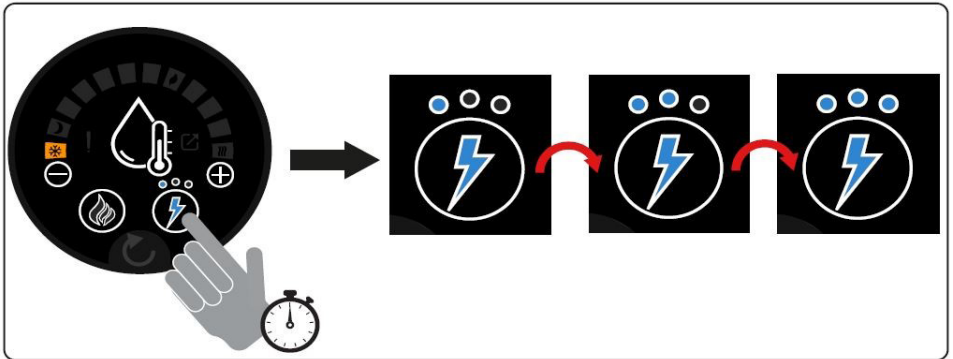

Press and hold the 'lightening' button on the controller to cycle through 0.38kW heating (One LED illuminated above button), 0.75kW (two LED's illuminated above button), and 1.5kW (three LED's illuminated above button) settings. Let go of the button when the desired setting is selected.

WHALE WATER HEATER ROUND CONTROL

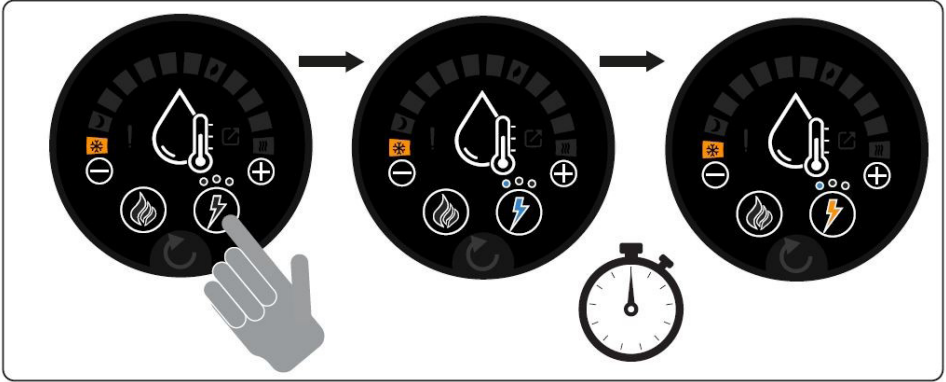

A single press of the 'lightening' button will turn electric water heating ON and OFF. When the button changes from Blue to Orange illumination, this confirms that electric heating is operational.



Ace Motorhomes

Dunswell Road
Cottingham
East Yorkshire
HU16 4JX

Customer Experience Team

enquiries@acemotorhomes.com

FIND OUT MORE AT **[ACEMOTORHOMES.COM](https://www.acemotorhomes.com)**